

TEC

THORNE'S EXCAVATING COMPANY, LLC

SINCE 1963

EQUIPMENT INFORMATION		EQUIPMENT DOWNTIME	COMPONENT CODES	
EQUIP. # <u>0007</u>		HOURS _____ DAYS _____	BASIC MACHINE HYDRAULIC ENGINE IMPLEMENTS	
MAKE <u>Dodge</u>		REASON	POWER TRAIN ELECTRIC DRIVE TRAIN UNEXPLAINED	
MODEL <u>2500</u>		PARTS _____ LABOR _____	COMPONENT LOCATION	
SERIAL # <u>Janitor</u>		OTHER _____	FRONT REAR LEFT RIGHT UPPER LOWER	
HOUR METER _____			OTHER _____	
MILES _____				
REASON FOR FAILURE: BROKEN WORN ABUSE LOOSE SEIZED			DATE: _____ DATE COMPLETED <u>10-18-17</u>	
OVERHEAT PLANNED CONTAM LEAKING NOISY SCRATCH			MECHANIC <u>Steven B.</u>	
SMOKES SHORTED VIBRATE OTHER _____			JOB NAME/LOCATION	JOB NUMBER
			<u>Southern Bank</u>	
PROBLEM: <u>1000 watt power inverter went bad.</u>				
REPAIRED: <u>replaced inverter with 2k watt</u>				
PARTS: <u>2k watt</u> <u>152. LE</u> <u>Advance Auto Parts</u>				
<u>Schumacher PC2000</u>				

TEC

THORNE'S EXCAVATING COMPANY, LLC

SINCE 1963

EQUIPMENT INFORMATION EQUIP. # <u>7</u> MAKE <u>Dodge</u> MODEL <u>17250</u> SERIAL # <u>Jander</u> HOUR METER _____ MILES <u>23.5K mi.</u>	EQUIPMENT DOWNTIME HOURS _____ DAYS _____ REASON _____ PARTS _____ LABOR _____ OTHER _____	COMPONENT CODES BASIC MACHINE HYDRAULIC ENGINE IMPLEMENTS POWER TRAIN ELECTRIC DRIVE TRAIN UNEXPLAINED COMPONENT LOCATION FRONT REAR LEFT RIGHT UPPER LOWER OTHER _____		
REASON FOR FAILURE: BROKEN WORN ABUSE LOOSE SEIZED OVERHEAT PLANNED CONTAM LEAKING NOISY SCRATCH SMOKES SHORTED VIBRATE OTHER _____		DATE: _____ DATE COMPLETED <u>11-27-17</u> MECHANIC <u>James Steven</u> <table border="1" style="width:100%; border-collapse: collapse;"> <tr> <td style="width:50%;">JOB NAME/LOCATION <u>Shop</u></td> <td style="width:50%;">JOB NUMBER</td> </tr> </table>	JOB NAME/LOCATION <u>Shop</u>	JOB NUMBER
JOB NAME/LOCATION <u>Shop</u>	JOB NUMBER			
PROBLEM: <u>power inverter</u>				
REPAIRED: <u>replaced inverter warranty, Advance auto parts</u> <u>ran large no. 4 cable + 40A breaker to inverter</u>				
PARTS: <u>warranty</u>				

PREMIER DODGE CHRYSLER JEEP OF LEBANON, LLC

600 Pleasant Grove Rd.
Mount Juliet, TN 37122
(615) 288-8525

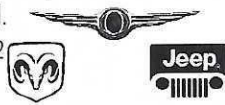

SERVICE DEPARTMENT HOURS
7:30 a.m. to 6:00 p.m.
Monday - Friday
8:00 a.m. - 4:00 p.m. Saturday

R/O Open Date	R/O Number
3/29/18	6097226/1
R/O Close Date	Status
3/29/18	Pre-Invoice
Mileage In	Mileage Out
35070	35071
Service Advisor / Tag #	
JONATHAN/238	
Vehicle Identification Number	
3C6UR4HL5HG580373	
Delivery Date	In-Service Date
11/18/16	11/18/16
Color	License Number
FLAME RED	

THORNES EXCAVATING CO LLC
624 OLD HORN SPRINGS RD
LEBANON, TN 37087-1811

Year	Make	Model	Work Phone	Home Phone	Body	Vehicle Identification Number	Delivery Date	In-Service Date	License Number
2017	RAM	2500		615-444-6523	TRADESMAN 4X2 CRE	3C6UR4HL5HG580373	11/18/16	11/18/16	
D5932									

DESCRIPTION OF SERVICE AND PARTS	AMOUNT
Email: erict@tec63.com	
#1 - RECALL: RECALL RECALL / CSN 1 T51: SAFETY RECALL T51 - DIESEL WATER PUMP** Tech: MARK FAUST (351) Installed CS2HT511AA :CAMPAIGN: WATER PUMP Qty: 1 Installed 68163848AB :ANTIFREEZ: COOLANT Qty: 2 REPLACE PUMP	Warranty Warranty Warranty
#2 - RECALL: RECALL RECALL / CSN 2 T79: SAFETY RECALL T79 - BRAKE TRANSMISSION SHIFT INTERLOCK** Tech: MARK FAUST (351) INSPECT AND FLASH	Warranty
#3 - INSP: VEHICLE INSPECTION 23 POINTS CHECK LIST MULTI-POINT INSPECTION (ACCORDING TO MAINTENANCE INTERVAL) Tech: MARK FAUST (351) Sub Total: .00	
#4 - AXELFL: CHANGE AXEL FLUID INSPECT REAR AXLE FLUID (INSPECT AND REPLACE IF NECESSARY AT EVERY 20,000 MILES) Tech: MARK FAUST (351) COMPLETED INSPECTION Sub Total: .00	
TERMS: STRICTLY CASH UNLESS ARRANGEMENTS ARE MADE. "I hereby authorize the repair work hereinafter to be done along with the necessary material and agree that you are not responsi- ble for loss or damage to vehicle or articles left in the vehicle in case of fire, theft, or any other cause beyond your control or for any delays caused by unavailability of parts or delays in parts shipments by the supplier or transporter. I hereby grant you or your employees permission to operate the vehicle herein described on streets, highways, or elsewhere for the purpose of testing and/or inspection. An express mechanic's lien is hereby acknowledged on above vehicle to secure the amount of repairs thereto."	
DISCLAIMER OF WARRANTIES: Any warranties on the products sold hereby are those made by the manufacturer. The seller hereby expressly disclaims all warranties either express or implied, includ- ing any implied warranty of merchantability or fitness for a particular purpose, and the seller neither assumes nor authorizes any other person to assume for it any liability in connection with the sale of said products. Any limitation contained herein does not apply where prohibited by law.	
LABOR	.00
PARTS	.00
DEDUCTIBLE	.00
SUBLET	.00
SHOP SUPPLIES	.00
HAZARDOUS MATERIALS	.00
SALES TAX OR TAX I.D.	.00
SPECIAL ORDER DEPOSIT	.00
DISCOUNTS	.00
TOTAL DUE	.00
NO RETURN ON ELECTRICAL OR SAFETY ITEMS OR SPECIAL ORDERS.	
X	
(C) 2009 DEALERTRACK SYSTEMS, Inc. - Dealership Application Group (800) 945-1028	

THORNE'S EXCAVATING COMPANY, LLC
SINCE 1963

EQUIPMENT INFORMATION

EQUIP. # 0007

MAKE 16 Ram

MODEL 2500

SERIAL # Sander

HOUR METER

MILES 55,154

EQUIPMENT DOWNTIME

HOURS _____ DAYS _____

REASON

PARTS

LABOR

OTHER

COMPONENT CODES

BASIC MACHINE HYDRAULIC ENGINE IMPLEMENTS

POWER TRAIN ELECTRIC DRIVE TRAIN UNEXPLAINED

COMPONENT LOCATION

FRONT REAR LEFT RIGHT UPPER LOWER

OTHER

REASON FOR FAILURE: BROKEN WORN ABUSE LOOSE SEIZED

OVERHEAT PLANNED CONTAM LEAKING NOISY SCRATCH

SMOKES SHORTED VIBRATE OTHER.

DATE: _____ DATE COMPLETED 9-10-19

MECHANIC Charlie's

JOB NAME/LOCATION

CHARLIE'S TIVE

JOB NUMBER

PROBLEM:

REPAIRED: Replaced tires

PARTS: 4 lines

953. 917

Charlie's Time

Toy 265/70-17

TEC
THORNE'S EXCAVATING COMPANY, LLC
SINCE 1963

EQUIPMENT INFORMATION EQUIP. # <u>0007</u> MAKE <u>Ram</u> MODEL <u>17' 2500</u> SERIAL # <u>Jaden</u> HOUR METER _____ MILES <u>56,934 mi</u>	EQUIPMENT DOWNTIME HOURS _____ DAYS _____ REASON _____ PARTS _____ LABOR _____ OTHER _____	COMPONENT CODES BASIC MACHINE HYDRAULIC ENGINE IMPLEMENTS POWER TRAIN ELECTRIC DRIVE TRAIN UNEXPLAINED COMPONENT LOCATION FRONT REAR LEFT RIGHT UPPER LOWER OTHER _____ _____
REASON FOR FAILURE: BROKEN WORN ABUSE LOOSE SEIZED OVERHEAT PLANNED CONTAM LEAKING NOISY SCRATCH SMOKES SHORTED VIBRATE OTHER _____		DATE: _____ DATE COMPLETED <u>1-31-19</u> MECHANIC <u>James</u> JOB NAME/LOCATION <u>Shop</u> JOB NUMBER _____
PROBLEM: <u>bad battery</u> _____ _____		
REPAIRED: <u>replaced batteries</u> _____ _____ _____ _____ _____ _____ _____		
PARTS: <u>2 MTX-94R 405.78 Interstate battery</u> _____ _____ _____ _____		

013 - Frame, Bumper and Fascia 240 - Bumper Front

Dealer Comments:

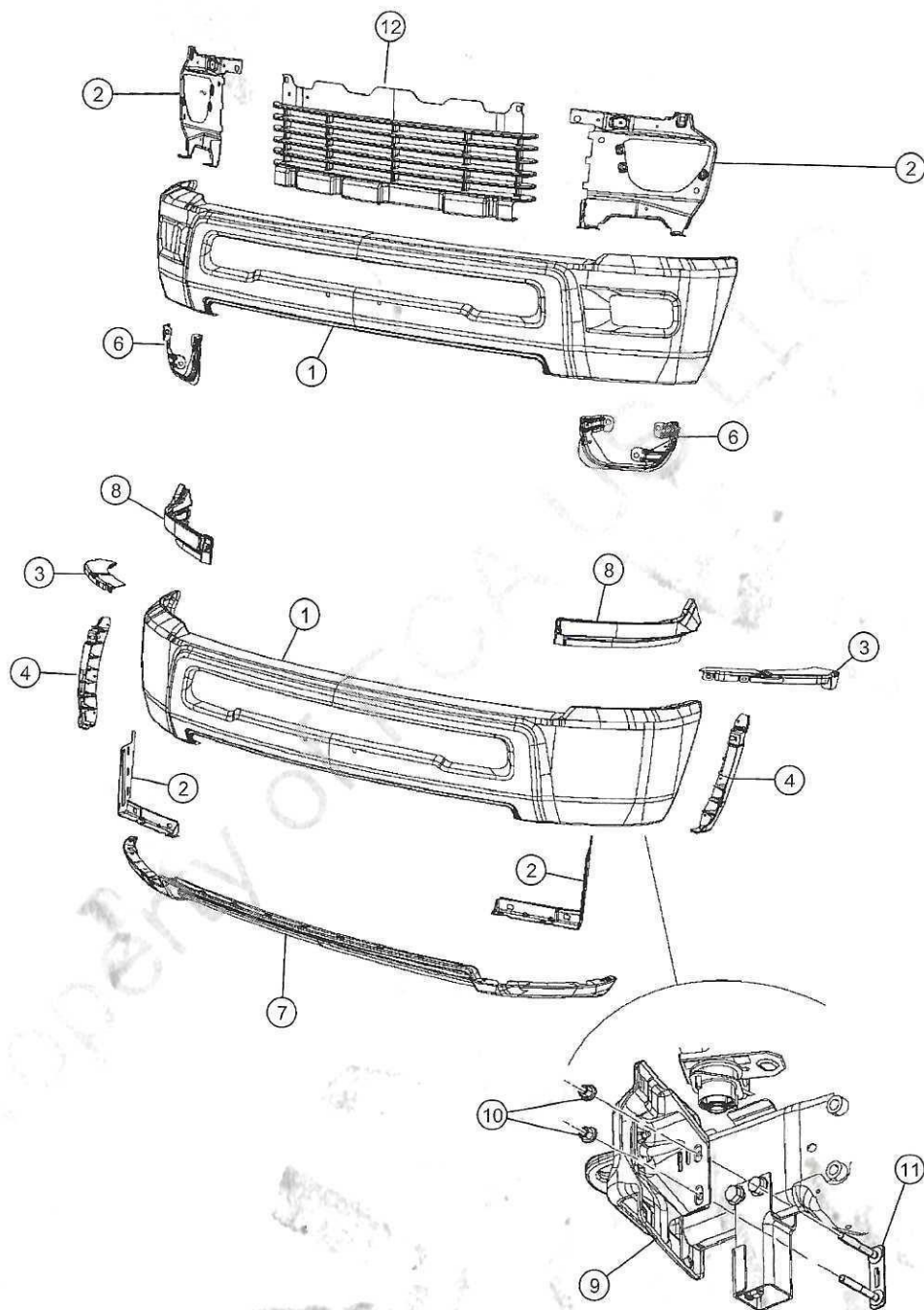

TEC

THORNE'S EXCAVATING COMPANY, LLC
SINCE 1963

EQUIPMENT INFORMATION		EQUIPMENT DOWNTIME		COMPONENT CODES	
EQUIP. # <u>7</u>		HOURS _____ DAYS _____		BASIC MACHINE HYDRAULIC ENGINE IMPLEMENTS	
MAKE <u>Ram</u>		REASON _____		POWER TRAIN ELECTRIC DRIVE TRAIN UNEXPLAINED	
MODEL <u>17' 2500</u>		PARTS _____ LABOR _____		COMPONENT LOCATION	
SERIAL # <u>Jawlen</u>		OTHER _____		FRONT REAR LEFT RIGHT UPPER LOWER	
HOUR METER _____				OTHER _____	
MILES _____					

REASON FOR FAILURE: BROKEN WORN ABUSE LOOSE SEIZED		DATE: <u>12-17-18</u> DATE COMPLETED _____	
OVERHEAT PLANNED CONTAM LEAKING NOISY SCRATCH		MECHANIC <u>Al/Charles</u>	
SMOKES SHORTED VIBRATE OTHER _____		JOB NAME/LOCATION <u>Shop</u> JOB NUMBER _____	

PROBLEM: hit DA-50 roller
RT headlamp & bumper damage

REPAIRED: replaced RT headlamp & base assembly
lower strip, bumper & bumper parts & spoiler.

PARTS: <u>Bumper, headlamp & strip</u>	<u>736.⁵⁴</u>	<u>Premier</u>
<u>2-wheel sensors</u>	<u>194.⁶⁰</u>	<u>Charles Tire</u>
<u>headlamp base & bumper parts</u>	<u>324.⁶¹</u>	<u>Premier</u>

TEC

THORNE'S EXCAVATING COMPANY, LLC

SINCE 1963

EQUIPMENT INFORMATION		EQUIPMENT DOWNTIME	COMPONENT CODES	
EQUIP. # <u>00057</u>	MAKE <u>Ram</u>	HOURS _____ DAYS _____	BASIC MACHINE HYDRAULIC ENGINE IMPLEMENTS	
MODEL <u>17' 2500</u>	SERIAL # _____	REASON _____	POWER TRAIN ELECTRIC DRIVE TRAIN UNEXPLAINED	
HOURLY METER <u>8</u>	MILES <u>83,200 mi</u>	PARTS _____ LABOR _____	COMPONENT LOCATION	
		OTHER _____	FRONT REAR LEFT RIGHT UPPER LOWER	
			OTHER _____	
REASON FOR FAILURE: BROKEN WORN ABUSE LOOSE SEIZED			DATE: _____ DATE COMPLETED <u>6-1-20</u>	
OVERHEAT PLANNED CONTAM LEAKING NOISY SCRATCH			MECHANIC <u>James + Bryan</u>	
SMOKES SHORTED VIBRATE OTHER _____			JOB NAME/LOCATION <u>Shop + Tire Shop</u>	JOB NUMBER _____
PROBLEM: <u>Service, tires & brakes</u>				
REPAIRED: <u>New tires Charlie's Tire</u>				
<u>new pads All four wheels</u>				
<u>serviced</u>				
PARTS: <u>4-265-70-17</u>				
<u>brakes</u>				
<u>176.08</u>				
<u>Charlie's Tire</u>				
<u>Advance</u>				
<u>new cabin filter</u>				

TEC

THORNE'S EXCAVATING COMPANY, LLC
SINCE 1963

EQUIPMENT INFORMATION		EQUIPMENT DOWNTIME	COMPONENT CODES	
EQUIP. # <u>0007</u>	HOURS _____ DAYS _____ REASON PARTS _____ LABOR _____ OTHER _____	BASIC MACHINE HYDRAULIC ENGINE IMPLEMENTS		
MAKE <u>RAM</u>		POWER TRAIN ELECTRIC DRIVE TRAIN UNEXPLAINED		
MODEL <u>17' 2500</u>		COMPONENT LOCATION		
SERIAL # <u>Josh</u>		FRONT REAR LEFT RIGHT UPPER LOWER		
HOUR METER _____		OTHER _____		
MILES _____				
REASON FOR FAILURE: BROKEN WORN ABUSE LOOSE SEIZED OVERHEAT PLANNED CONTAM LEAKING NOISY SCRATCH SMOKES SHORTED VIBRATE OTHER _____		DATE: <u>8-4-20</u>	DATE COMPLETED <u>9-3-20</u>	
		MECHANIC <u>All</u>		
		JOB NAME/LOCATION <u>All</u>	JOB NUMBER _____	
PROBLEM: <u>Inner fender well worn through by tire</u>				
REPAIRED: <u>replaced fender well RT front</u> <u>recalled occupant restraint & tailgate latch</u> <u>took to Premier</u>				
PARTS: <u>RT front fender well 110.51 Premier Ram</u>				

TEC

THORNE'S EXCAVATING COMPANY, LLC
SINCE 1963

EQUIPMENT INFORMATION		EQUIPMENT DOWNTIME	COMPONENT CODES	
EQUIP. # <u>0007</u>		HOURS _____ DAYS _____	BASIC MACHINE HYDRAULIC ENGINE IMPLEMENTS	
MAKE <u>Rsm</u>		REASON _____	POWER TRAIN ELECTRIC DRIVE TRAIN UNEXPLAINED	
MODEL <u>17' 2500</u>		PARTS _____ LABOR _____	COMPONENT LOCATION	
SERIAL # <u>J6sh</u>		OTHER _____	FRONT REAR LEFT RIGHT UPPER LOWER	
HOUR METER _____			OTHER _____	
MILES _____				
REASON FOR FAILURE: BROKEN WORN ABUSE LOOSE SEIZED OVERHEAT PLANNED CONTAM LEAKING NOISY SCRATCH SMOKES SHORTED VIBRATE OTHER _____			DATE <u>12-1-20</u> DATE COMPLETED <u>12-1-20</u> MECHANIC <u>James</u>	
			JOB NAME/LOCATION <u>Shop</u>	JOB NUMBER
PROBLEM: <u>one bad battery</u>				
REPAIRED: <u>replaced one battery</u>				
ARTS: <u>MTX-94R/H17</u> <u>195.30</u> <u>Interstate Battery</u>				
<u>Richard No. 139.99</u>				
<u>AGM 189.99</u>				

TEC

THORNE'S EXCAVATING COMPANY, LLC

SINCE 1963

EQUIPMENT INFORMATION		EQUIPMENT DOWNTIME	COMPONENT CODES	
EQUIP. # <u>0007</u>		HOURS _____ DAYS _____	BASIC MACHINE HYDRAULIC ENGINE IMPLEMENTS	
MAKE <u>Ram</u>		REASON _____	POWER TRAIN ELECTRIC DRIVE TRAIN UNEXPLAINED	
MODEL <u>17'</u>		PARTS _____ LABOR _____	COMPONENT LOCATION	
SERIAL # _____		OTHER _____	FRONT REAR LEFT RIGHT UPPER LOWER	
HOUR METER _____			OTHER _____	
MILES _____				
REASON FOR FAILURE: BROKEN WORN ABUSE LOOSE SEIZED			DATE <u>5-13-21</u> DATE COMPLETED <u>5-13-21</u>	
OVERHEAT PLANNED CONTAM LEAKING NOISY SCRATCH			MECHANIC <u>James</u>	
SMOKES SHORTED VIBRATE OTHER _____			JOB NAME/LOCATION <u>Shop</u>	JOB NUMBER _____
PROBLEM: <u>missing spoiler + front Air Dam</u>				
REPAIRED: <u>replaced spoiler</u>				
PARTS: <u>Spoiler + Air Dam 310.89</u> <u>Premier Ram</u>				

TEC

THORNE'S EXCAVATING COMPANY, LLC

SINCE 1963

EQUIPMENT INFORMATION		EQUIPMENT DOWNTIME		COMPONENT CODES	
EQUIP. # <u>0007</u>		HOURS _____ DAYS _____		BASIC MACHINE HYDRAULIC ENGINE IMPLEMENTS	
MAKE <u>Ram</u>		REASON		POWER TRAIN ELECTRIC DRIVE TRAIN UNEXPLAINED	
MODEL <u>17' 2500</u>		PARTS _____ LABOR _____		COMPONENT LOCATION	
SERIAL # <u>Spare</u>		OTHER _____		FRONT REAR LEFT RIGHT UPPER LOWER	
HOUR METER _____				OTHER _____	
MILES _____					
REASON FOR FAILURE: BROKEN WORN ABUSE LOOSE SEIZED				DATE <u>10-2-21</u> DATE COMPLETED <u>11-4-21</u>	
OVERHEAT PLANNED CONTAM LEAKING NOISY SCRATCH				MECHANIC <u>Ben + Caleb</u>	
SMOKES SHORTED VIBRATE OTHER _____				JOB NAME/LOCATION <u>Shop</u> JOB NUMBER _____	
PROBLEM: <u>bad left rear door hinge</u>					
REPAIRED: <u>replaced hinge</u>					
PARTS: <u>door hinge</u> <u>68.63</u> <u>Premier Ram</u>					

TEC

THORNE'S EXCAVATING COMPANY, LLC

SINCE 1963

EQUIPMENT INFORMATION		EQUIPMENT DOWNTIME		COMPONENT CODES	
EQUIP. # <u>0007</u>		HOURS _____ DAYS _____		BASIC MACHINE HYDRAULIC ENGINE IMPLEMENTS	
MAKE <u>Ram</u>		REASON _____		POWER TRAIN ELECTRIC DRIVE TRAIN UNEXPLAINED	
MODEL <u>17' 2500</u>		PARTS _____ LABOR _____		COMPONENT LOCATION	
SERIAL # _____		OTHER _____		FRONT REAR LEFT RIGHT UPPER LOWER	
HOUR METER _____				OTHER _____	
MILES <u>100K mi</u>					
REASON FOR FAILURE: BROKEN WORN ABUSE LOOSE SEIZED OVERHEAT PLANNED CONTAM LEAKING NOISY SCRATCH SMOKES SHORTED VIBRATE OTHER _____				DATE <u>12-1-21</u> DATE COMPLETED <u>2-1-22</u> MECHANIC <u>James</u>	
PROBLEM: <u>bad studs & nuts</u>				JOB NAME/LOCATION <u>Shop</u> JOB NUMBER _____	
REPAIRED: <u>replaced stud & 2 nuts left front wheel</u> <u>Serviced</u>					
PARTS: <u>12-nuts & studs</u> <u>281.14</u> <u>Premier Ram</u>					

TEC

THORNE'S EXCAVATING COMPANY, LLC

SINCE 1963

EQUIPMENT INFORMATION		EQUIPMENT DOWNTIME	COMPONENT CODES	
EQUIP. # <u>00007</u>		HOURS _____ DAYS _____	BASIC MACHINE HYDRAULIC ENGINE IMPLEMENTS	
MAKE <u>Ram</u>		REASON _____	POWER TRAIN ELECTRIC DRIVE TRAIN UNEXPLAINED	
MODEL <u>17' 2800</u>		PARTS _____ LABOR _____	COMPONENT LOCATION	
SERIAL # _____		OTHER _____	FRONT REAR LEFT RIGHT UPPER LOWER	
HOUR METER _____			OTHER _____	
MILES <u>110K mi</u>				
REASON FOR FAILURE: BROKEN WORN ABUSE LOOSE SEIZED		DATE: _____ DATE COMPLETED <u>5-2-22</u>		
OVERHEAT PLANNED CONTAM LEAKING NOISY SCRATCH		MECHANIC <u>James & Ben</u>		
SMOKES SHORTED VIBRATE OTHER _____		JOB NAME/LOCATION <u>Shop</u>	JOB NUMBER _____	
PROBLEM: <u>service</u>				
REPAIRED: <u>serviced & new Tires</u>				
PARTS: <u>4- Toyo 265/70-17 1094.43 Charlie's Tire</u>				

TEC

THORNE'S EXCAVATING COMPANY, LLC
SINCE 1963

EQUIPMENT INFORMATION		EQUIPMENT DOWNTIME	COMPONENT CODES												
EQUIP. # <u>0007</u>	HOURS _____ DAYS _____ REASON _____ PARTS _____ LABOR _____ OTHER _____	BASIC MACHINE HYDRAULIC ENGINE IMPLEMENTS POWER TRAIN ELECTRIC DRIVE TRAIN UNEXPLAINED													
MAKE <u>Ram</u>		COMPONENT LOCATION													
MODEL <u>2500</u>		FRONT REAR LEFT RIGHT UPPER LOWER OTHER _____													
SERIAL # _____															
HOUR METER _____															
MILES <u>120k mi</u>															
REASON FOR FAILURE: BROKEN WORN ABUSE LOOSE SEIZED OVERHEAT PLANNED CONTAM LEAKING NOISY SCRATCH SMOKES SHORTED VIBRATE OTHER _____		DATE: <u>8.3.22</u> DATE COMPLETED <u>8.4.22</u> MECHANIC <u>ALL</u>													
PROBLEM: <u>noise in front & service</u>		JOB NAME/LOCATION <u>Shop</u> JOB NUMBER _____													
REPAIRED: <u>serviced, replaced left front tire & hub bearing. brake pads on all four. new track bar.</u>															
<table border="0"> <tr> <td>PARTS: <u>Hub</u></td> <td><u>242.53</u></td> <td><u>Advance</u></td> </tr> <tr> <td><u>Tire</u></td> <td><u>273.61</u></td> <td><u>Charles Tire</u></td> </tr> <tr> <td><u>Pads</u></td> <td><u>129.58</u></td> <td><u>Advance</u></td> </tr> <tr> <td><u>Track bar</u></td> <td><u>312.46</u></td> <td><u>Premier Ram</u></td> </tr> </table>				PARTS: <u>Hub</u>	<u>242.53</u>	<u>Advance</u>	<u>Tire</u>	<u>273.61</u>	<u>Charles Tire</u>	<u>Pads</u>	<u>129.58</u>	<u>Advance</u>	<u>Track bar</u>	<u>312.46</u>	<u>Premier Ram</u>
PARTS: <u>Hub</u>	<u>242.53</u>	<u>Advance</u>													
<u>Tire</u>	<u>273.61</u>	<u>Charles Tire</u>													
<u>Pads</u>	<u>129.58</u>	<u>Advance</u>													
<u>Track bar</u>	<u>312.46</u>	<u>Premier Ram</u>													

TEC

THORNE'S EXCAVATING COMPANY, LLC
SINCE 1963

EQUIPMENT INFORMATION		EQUIPMENT DOWNTIME	COMPONENT CODES
EQUIP. # <u>0007</u>	HOURS _____ DAYS _____	BASIC MACHINE HYDRAULIC ENGINE IMPLEMENTS	
MAKE <u>Ram</u>	REASON _____	POWER TRAIN ELECTRIC DRIVE TRAIN UNEXPLAINED	
MODEL <u>17 2500</u>	PARTS _____ LABOR _____	COMPONENT LOCATION	
SERIAL # <u>MATY</u>	OTHER _____	FRONT REAR LEFT RIGHT UPPER LOWER	
HOUR METER _____		OTHER _____	
MILES _____			
REASON FOR FAILURE: BROKEN WORN ABUSE LOOSE SEIZED OVERHEAT PLANNED CONTAM LEAKING NOISY SCRATCH SMOKES SHORTED VIBRATE OTHER _____		DATE: <u>8-12-22</u> DATE COMPLETED <u>8-12-22</u> MECHANIC <u>Anthony</u>	
PROBLEM: <u>RT Front hub noise</u>		JOB NAME/LOCATION <u>Shop</u> JOB NUMBER _____	
REPAIRED: <u>Replaced RT front hubs</u>			
PARTS: <u>Hub</u> <u>266.19</u> <u>Advance Auto Parts</u>			

TEC

THORNE'S EXCAVATING COMPANY, LLC
SINCE 1963

EQUIPMENT INFORMATION		EQUIPMENT DOWNTIME		COMPONENT CODES	
EQUIP. # <u>0007</u>	MAKE <u>Ram</u>	HOURS _____ DAYS _____	REASON _____	BASIC MACHINE	HYDRAULIC ENGINE IMPLEMENTS
MODEL <u>17 2500</u>	SERIAL # <u>Marty</u>	PARTS _____ LABOR _____	OTHER _____	POWER TRAIN	ELECTRIC DRIVE TRAIN UNEXPLAINED
HOUR METER _____	MILES <u>131.5 K mi</u>			COMPONENT LOCATION	
				FRONT REAR LEFT RIGHT UPPER LOWER	
				OTHER _____	
REASON FOR FAILURE: BROKEN WORN ABUSE LOOSE SEIZED OVERHEAT PLANNED CONTAM LEAKING NOISY SCRATCH SMOKES SHORTED VIBRATE OTHER _____				DATE: <u>11-23-22</u> DATE COMPLETED <u>11-23-22</u> MECHANIC <u>Anthony</u>	
PROBLEM: <u>No. 6 shift</u>				JOB NAME/LOCATION <u>Shop</u> JOB NUMBER _____	
REPAIRED: <u>Torque Turbine speed</u> <u>changed oil & filters</u>					
PARTS: <u>Filter & Oil</u> <u>155.08</u> <u>Advance</u> <u>Trans. sensor</u> <u>50.36</u> <u>MT. Juliet Ram</u>					

TEC

THORNE'S EXCAVATING COMPANY, LLC

SINCE 1963

EQUIPMENT INFORMATION EQUIP. # <u>0007</u> MAKE <u>Ram</u> MODEL <u>17' 2500</u> SERIAL # _____ HOUR METER _____ MILES <u>135K mi</u>	EQUIPMENT DOWNTIME HOURS _____ DAYS _____ REASON _____ PARTS _____ LABOR _____ OTHER _____	COMPONENT CODES BASIC MACHINE HYDRAULIC ENGINE IMPLEMENTS POWER TRAIN ELECTRIC DRIVE TRAIN UNEXPLAINED COMPONENT LOCATION FRONT REAR LEFT RIGHT UPPER LOWER OTHER _____									
REASON FOR FAILURE: BROKEN WORN ABUSE LOOSE SEIZED OVERHEAT PLANNED CONTAM LEAKING NOISY SCRATCH SMOKES SHORTED VIBRATE OTHER _____		DATE: <u>1-17-23</u> DATE COMPLETED <u>1-23-23</u> MECHANIC <u>All</u> JOB NAME/LOCATION <u>Shop</u> JOB NUMBER _____									
PROBLEM: <u>No 5 solenoid issue</u> _____ _____											
REPAIRED: <u>changed Trans. oil & filters, solenoid assembly, speed sensor & Trans. oil pressure sensor.</u> _____ _____ _____ _____											
<table style="width:100%; border-collapse: collapse;"> <tr> <td style="width:33%;">PARTS: <u>oil & filter</u></td> <td style="width:33%; text-align: center;"><u>166.⁰²</u></td> <td style="width:33%; text-align: center;"><u>Advance</u></td> </tr> <tr> <td><u>solenoid assembly</u></td> <td style="text-align: center;"><u>432.²⁰</u></td> <td style="text-align: center;"><u>MT Juliet Ram</u></td> </tr> <tr> <td><u>speed sensor</u></td> <td style="text-align: center;"><u>31.²⁷</u></td> <td style="text-align: center;"><u>Advance</u></td> </tr> </table>			PARTS: <u>oil & filter</u>	<u>166.⁰²</u>	<u>Advance</u>	<u>solenoid assembly</u>	<u>432.²⁰</u>	<u>MT Juliet Ram</u>	<u>speed sensor</u>	<u>31.²⁷</u>	<u>Advance</u>
PARTS: <u>oil & filter</u>	<u>166.⁰²</u>	<u>Advance</u>									
<u>solenoid assembly</u>	<u>432.²⁰</u>	<u>MT Juliet Ram</u>									
<u>speed sensor</u>	<u>31.²⁷</u>	<u>Advance</u>									

TEC

THORNE'S EXCAVATING COMPANY, LLC
SINCE 1963

EQUIPMENT INFORMATION		EQUIPMENT DOWNTIME		COMPONENT CODES	
EQUIP. # <u>0009</u>		HOURS _____ DAYS _____		BASIC MACHINE	HYDRAULIC ENGINE IMPLEMENTS
MAKE <u>Ram</u>		REASON _____		POWER TRAIN	ELECTRIC DRIVE TRAIN UNEXPLAINED
MODEL <u>17' 2500</u>		PARTS _____ LABOR _____		COMPONENT LOCATION	
SERIAL # _____		OTHER _____		FRONT REAR LEFT RIGHT UPPER LOWER	
HOUR METER _____				OTHER _____	
MILES <u>138K mi</u>					
REASON FOR FAILURE: BROKEN WORN ABUSE LOOSE SEIZED			DATE <u>5-20-23</u> DATE COMPLETED _____		
OVERHEAT PLANNED CONTAM LEAKING NOISY SCRATCH			MECHANIC <u>ALL</u>		
SMOKES SHORTED VIBRATE OTHER _____			JOB NAME/LOCATION <u>To Shop</u> JOB NUMBER _____		
PROBLEM: <u>needs batteries, Transmission & Tires</u>					

REPAIRED: replaced batteries Transmission had sent to transmission shop Rebuilt Transmission Tires And alignment

PARTS: <u>47 AGM</u>	<u>461.30</u>	<u>Advance Auto Parts</u>
<u>Transmission</u>	<u>8801.95</u>	<u>Tiger Transmission</u>
<u>Tires 4-Toyo 265/70/17</u>	<u>1100.00</u>	<u>Charlier Tire</u>

This notice applies to your vehicle,

2017 RAM 2500

VIN: 3C6UR4HL5HG580373

67A

Alberto

12:00

1:00



RAM

YOUR SCHEDULING OPTIONS

1. **RECOMMENDED OPTION**

Call your authorized Chrysler / Dodge / Jeep® / RAM / Dealership.

2. Call the FCA Recall Assistance Center at **1-800-853-1403**. An agent can confirm part availability and help schedule an appointment.

3. Visit recalls.mopar.com, scan the QR code below, or download the Mopar Owner's Companion App.



Get access to recall notifications, locate your nearest dealer, and more through this website or Mopar Owner's Companion App. You will be asked to provide your Vehicle Identification Number (VIN) to protect and verify your identity. The last eight characters of your VIN are provided above.

DEALERSHIP INSTRUCTIONS

Please reference Emissions Recall

67A

IMPORTANT EMISSIONS RECALL

D Truck Engine Calibration

Dear THORNES EXCAVATING CO,

FCA US LLC, has determined that certain 2017 RAM 2500 trucks equipped with a 6.7L Cummins Turbo Diesel engine requires upgraded emission control software according to Federal and California regulations/standards.

WHY DOES MY VEHICLE NEED REPAIRS?

The engine control software in your vehicle ^[1] must be updated with an upgraded calibration as required by the US Environmental Protection Agency and California Air Resources Board for better emission performance.

HOW DO I RESOLVE THIS IMPORTANT EMISSIONS ISSUE?

FCA will repair your truck free of charge (parts and labor). To do this, your dealer will reprogram the Powertrain Control Module (PCM). The estimated repair time is one hour. In addition, your dealer will require your vehicle for proper check-in, preparation, and check-out during your visit, which require more time. Your time is important to us, so we recommend that you schedule a service appointment to minimize your inconvenience. Please bring this letter with you to your dealership.

**TO SCHEDULE YOUR FREE REPAIR,
CALL YOUR CHRYSLER, DODGE, JEEP OR RAM DEALER TODAY**

CALIFORNIA RESIDENTS

The State of California requires the completion of this emission recall repair prior to vehicle registration renewal. Your dealer will provide you with a Vehicle Emission Recall Proof of Correction Form after the Emission Recall service is performed. Be sure to save this form since the California Department of Motor Vehicles may require that you supply it as proof that the Emission Recall has been performed.

In order to ensure your full protection under the emissions warranty provisions, it is recommended that you have your vehicle serviced as soon as possible. Failure to do so could be determined as lack of proper maintenance of your vehicle.

WHAT IF I ALREADY PAID TO HAVE THIS REPAIR COMPLETED?

If you have already experienced this specific condition and have paid to have it repaired, you may visit www.fcarecallreimbursement.com to submit your reimbursement request online. ^[2] Once we receive and verify the required documents, reimbursement will be sent to you within 60 days. If you have had previous repairs performed and/or already received reimbursement, you may still need to have the recall repair performed.

We apologize for any inconvenience, but are sincerely concerned about your satisfaction. Thank you for your attention to this important matter.

Customer Assistance/Field Operations
FCA US LLC

TEC

THORNE'S EXCAVATING COMPANY, LLC

SINCE 1963

EQUIPMENT INFORMATION		EQUIPMENT DOWNTIME	COMPONENT CODES	
EQUIP. # <u>0007</u>		HOURS _____ DAYS _____	BASIC MACHINE HYDRAULIC ENGINE IMPLEMENTS	
MAKE <u>Ram</u>		REASON _____	POWER TRAIN ELECTRIC DRIVE TRAIN UNEXPLAINED	
MODEL <u>17' 2500</u>		PARTS _____ LABOR _____	COMPONENT LOCATION	
SERIAL # _____		OTHER _____	FRONT REAR LEFT RIGHT UPPER LOWER	
HOUR METER _____			OTHER _____	
MILES _____				
REASON FOR FAILURE: BROKEN WORN ABUSE LOOSE SEIZED			DATE: _____ DATE COMPLETED <u>2-1-24</u>	
OVERHEAT PLANNED CONTAM LEAKING NOISY SCRATCH			MECHANIC <u>Ben</u>	
SMOKES SHORTED VIBRATE OTHER _____			JOB NAME/LOCATION <u>To Shop</u>	JOB NUMBER _____
PROBLEM: <u>bad throttle response</u>				
REPAIRED: <u>replaced Pedal sensor</u>				
PARTS: <u>Pedal sensor</u> <u>243.26</u> <u>MT Juliet Ram</u>				

TEC

THORNE'S EXCAVATING COMPANY, LLC

SINCE 1963

EQUIPMENT INFORMATION		EQUIPMENT DOWNTIME	COMPONENT CODES	
EQUIP. # <u>00017</u>		HOURS _____ DAYS _____	BASIC MACHINE HYDRAULIC ENGINE IMPLEMENTS	
MAKE <u>Ram</u>		REASON _____	POWER TRAIN ELECTRIC DRIVE TRAIN UNEXPLAINED	
MODEL <u>17' 2500</u>		PARTS _____ LABOR _____	COMPONENT LOCATION	
SERIAL # _____		OTHER _____	FRONT REAR LEFT RIGHT UPPER LOWER	
HOUR METER _____			OTHER _____	
MILES <u>148k mi</u>				
REASON FOR FAILURE: BROKEN WORN ABUSE LOOSE SEIZED			DATE <u>3-6-24</u> DATE COMPLETED <u>3-6-24</u>	
OVERHEAT PLANNED CONTAM LEAKING NOISY SCRATCH			MECHANIC <u>Ali</u>	
SMOKES SHORTED VIBRATE OTHER _____			JOB NAME/LOCATION <u>To shop</u>	JOB NUMBER _____
PROBLEM: <u>brake noise</u>				
REPAIRED: <u>replaced front pads & rotors, + rear pads</u>				
PARTS: <u>pads + front rotors</u> <u>336.³¹</u> <u>Advance</u>				